

## HF 'F' overslung suspension

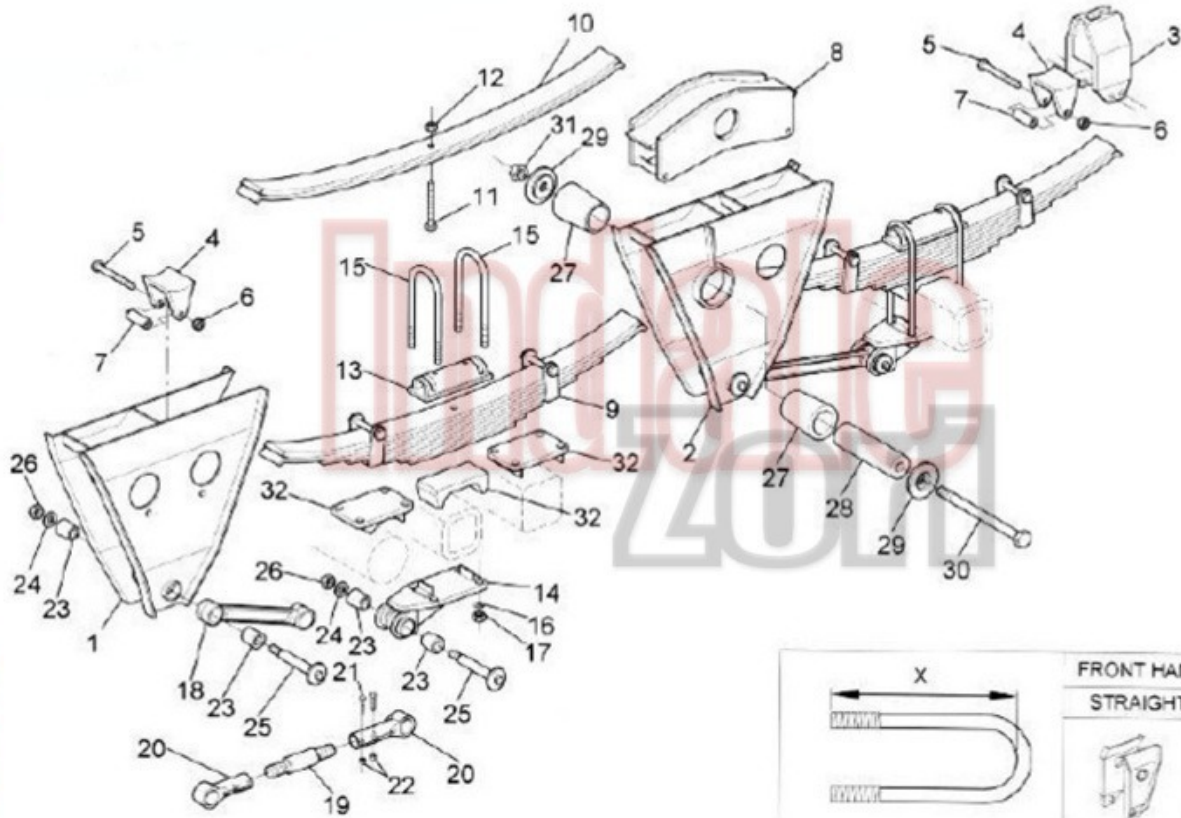

- |   |                             |                                   |
|---|-----------------------------|-----------------------------------|
| 1. Front Hanger -<br>Tapered Straight               | 14. Axle Seat -<br>Sq Axles | 24. Washer 25 Dia                 |
| 2. Rocker Hanger                                    | 15. U Bolt -<br>Dim X = 340 | 25. Radius Rod Pin                |
| 3. Rear Hanger                                      | Dim X = 380                 | 26. Nyloc Nut M24                 |
| 4. Wear Plate Assy -<br>C/w Bolt, Nut & Spacer Tube | Dim X = 300                 | 27. Rocker Bush -<br>Rubber       |
| 5. Bolt M16 x 150                                   | Dim X = 320                 | 28. Rocker Spacer Tube            |
| 6. Nyloc Nut M16                                    | Dim X = 390                 | 29. Retainer Washer               |
| 7. Spacer Tube                                      | Dim X = 410                 | 30. Bolt M20 x 250                |
| 8. Rocker   | 16. Washer 22 Dia           | 31. Nyloc Nut M20                 |
| 9. Spring -<br>8 Blade                              | 17. Nyloc Nut M22           | 32. Spring Chair -<br>127 Sq Axle |
| 9 Blade   | 18. Radius Rod - Fixed      | 127 Dia Axle                      |
| 10. Main Blade Set -<br>8 Blade                     | 19. Adjuster                | 105 Sq Axle                       |
| 9 Blade   | 20. Radius Rod End -<br>LH  | 112 Sq Axle                       |
| 11. Centre Bolt M14 x 145                           | RH                          |                                   |
| 12. Nut M14   | 21. Bolt M12 x 55           |                                   |
| 13. Saddle  | 22. Nyloc Nut M12           |                                   |
|   | 23. Radius Rod Bush         |                                   |

